

# ACCOMMODATION AND SLEEPING PLANNER



Please see below for individual hut details and location within the camp site. Huts are allocated by the Kerem Team prior to your camp. Please contact us if the allocation is not suitable. Additional hut can be hired for \$250.00 per hut per night.

## HUT DETAILS

HUT	MAX PERSONS	BED STYLE
Hut 1	19-20	1 x Queen Bed, 9 x Bunk Beds
Hut 2a	28	14 x Bunk Bed
Hut 2b	19	9 x Bunk Beds 1 x Single Bed
Hut 3	38	17 x Bunk Beds, 4 x Queen Bed
Hut 4	17	15 x Single Beds 1 x Bunk Beds
Hut 5	21	5 x Bunk Beds, 11 Single Beds
The Lodge	3-6	3 x Double Beds, 3 x Ensuities

## SITE MAP

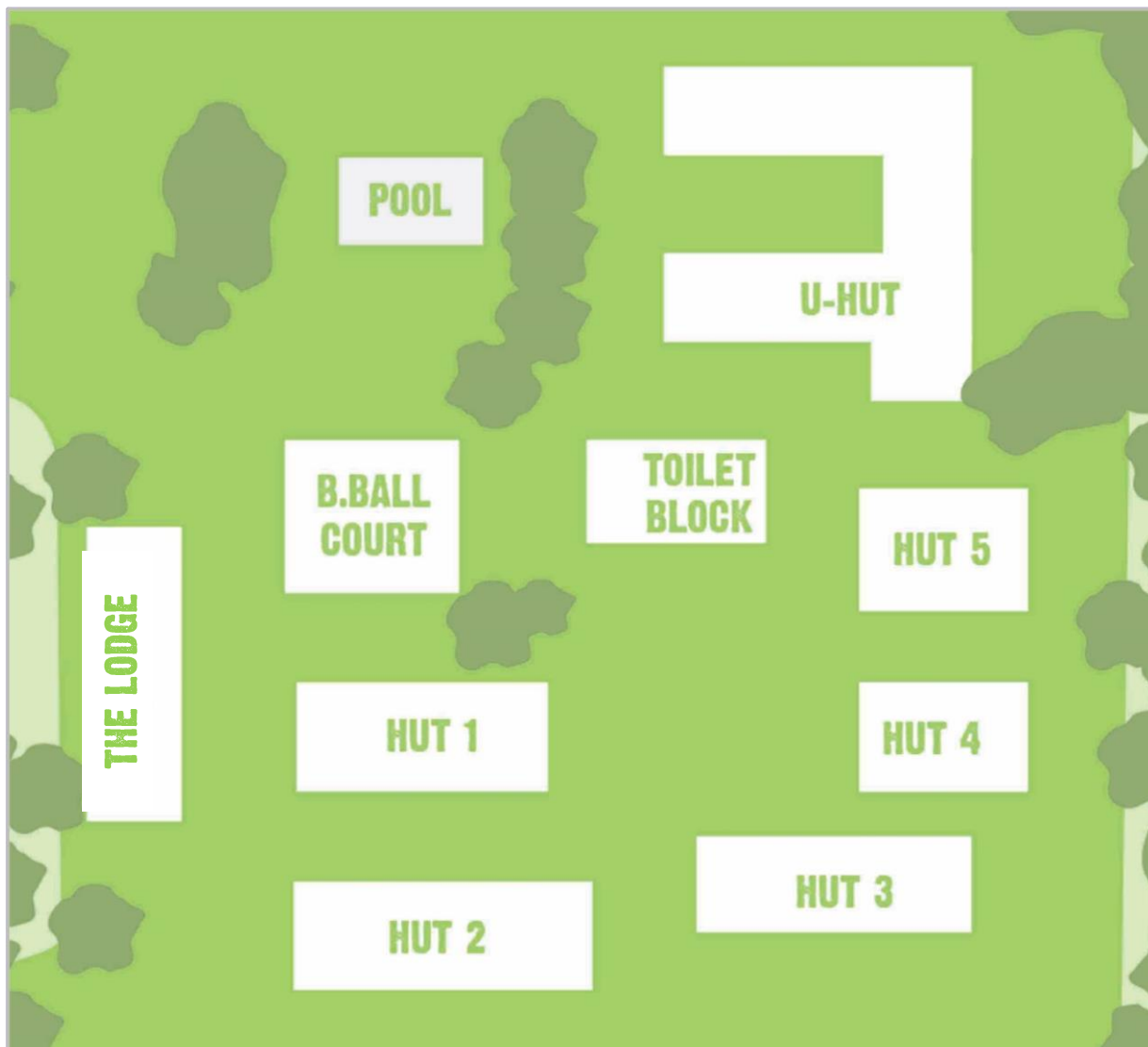



# HUT 1

Hut 1 has an open sitting room and sleeps up to 19-20 campers and includes:

- 1 room with a queen bed
- 9 rooms with 1 x bunk bed

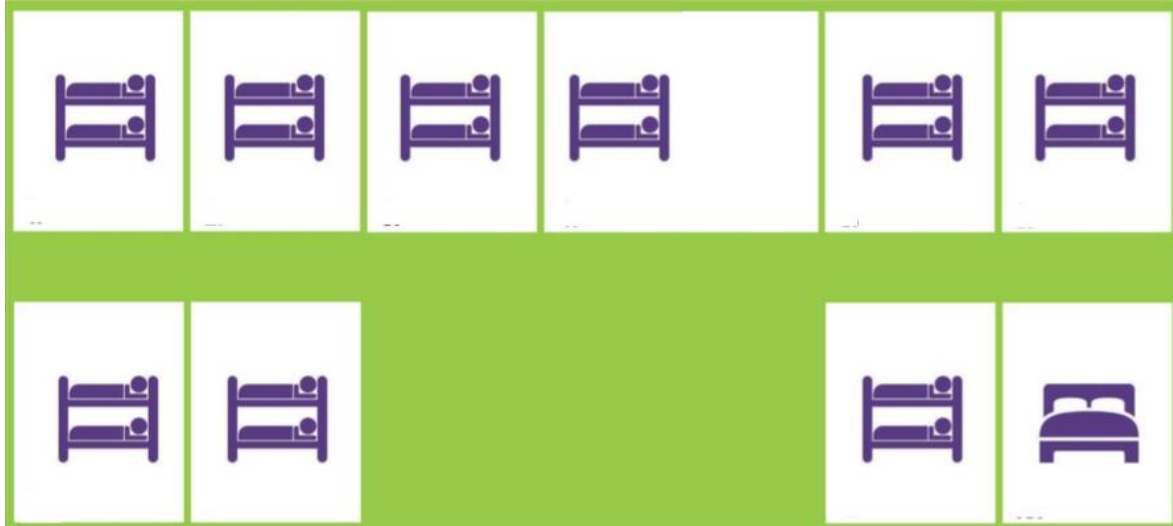

# HUT 2

Hut 2 can be divided into 2 sections 2A and 2B sleeping up to 47 campers. Hut 2B cannot be used in isolation from Hut 2A

## HUT 2A:

- 1 room with 7 bunk beds
- 2 room with 3 x bunk beds
- 1 room with 1 x bunk beds

## HUT 2B:

- 2 rooms with 3 bunk beds
- 1 room with 2 x bunk beds
- 1 room with 1 x bunk bed
- 1 room with 1 single bed

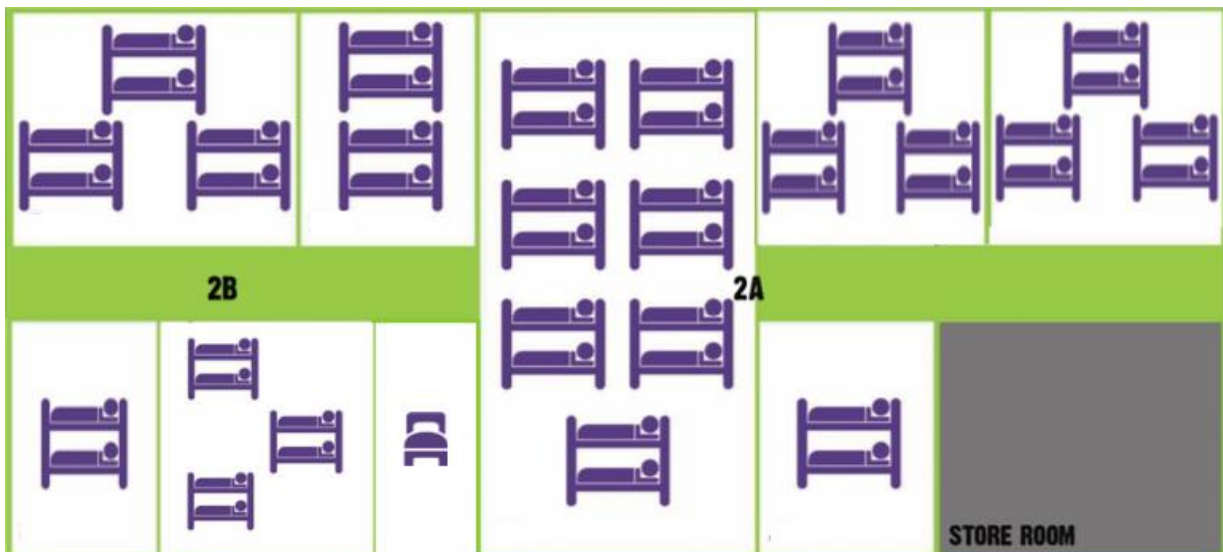



# HUT 3

Hut 3 includes a sitting room and sleeps up to 38 campers in the following rooms:

- 2 rooms with 4 bunk beds
- 1 room with 2 single beds
- A large open room with 9 bunk beds and 2 single beds

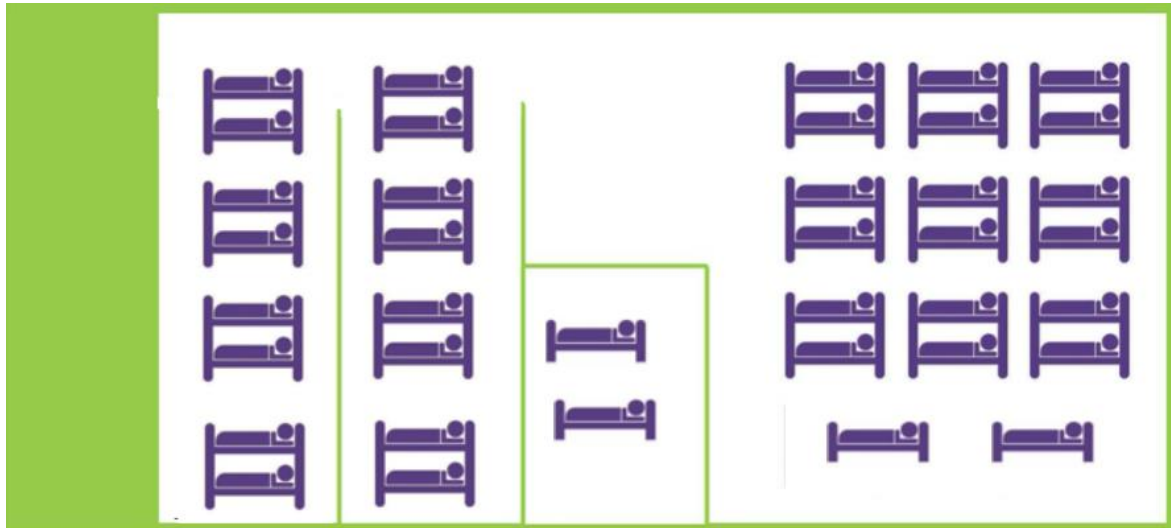

# HUT 4

Hut 4 sleeps up to 16 campers in 8 rooms each containing 2 single beds.

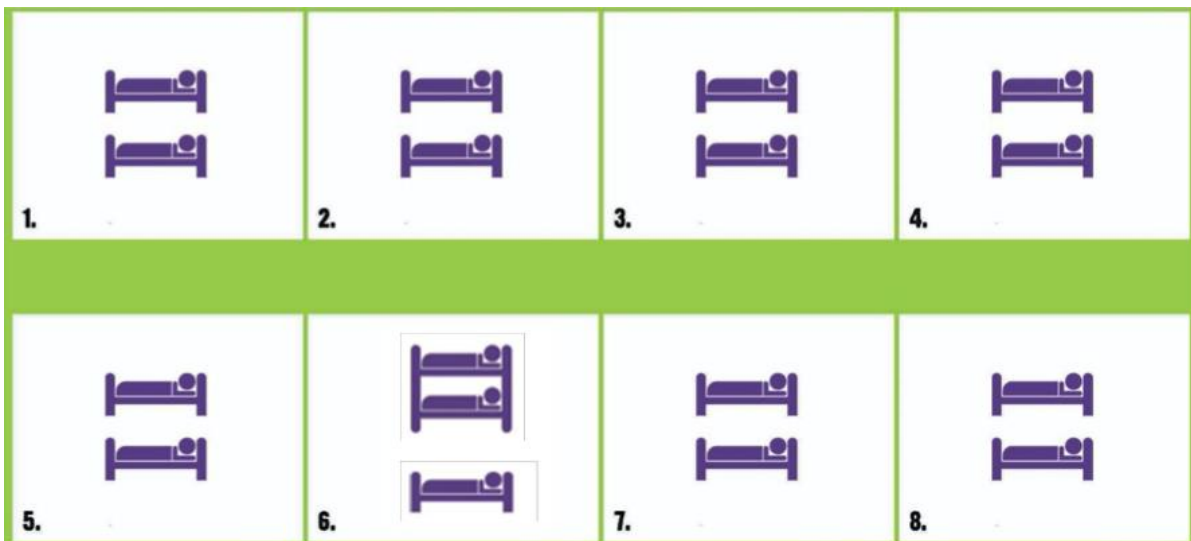



## HUT 5

Hut 5 sleeps up to 20 campers and includes:

- 2 rooms with 2 x bund beds, 2 single beds
- 4 rooms with 2 x single beds

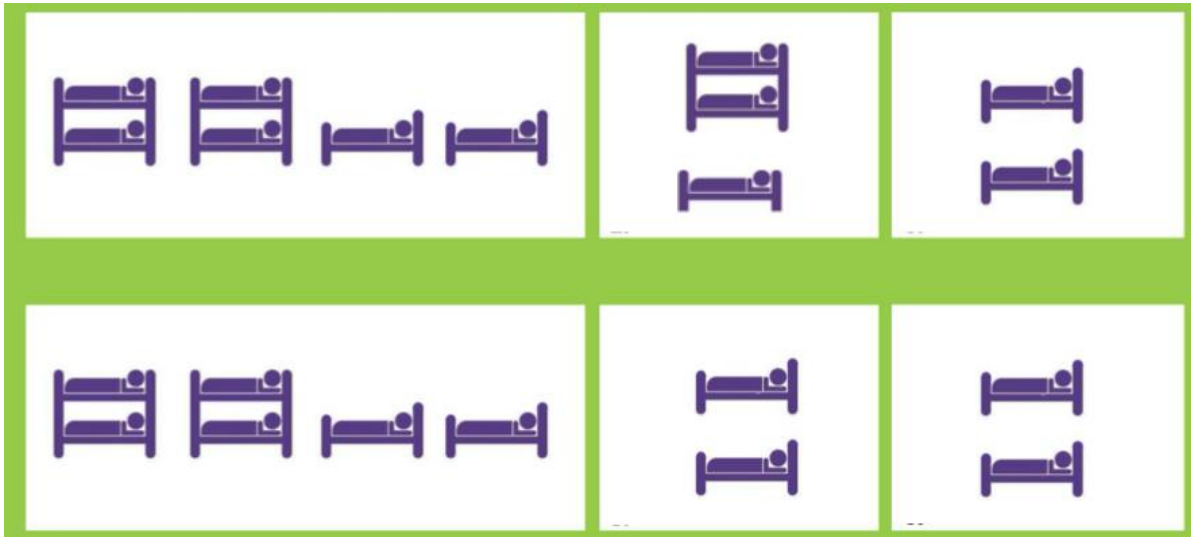

## THE LODGE

The Lodge sleeps up to 6 campers and includes:

- 3 rooms with 1 x double beds – rooms 1, 2 and 3
- Each room features a private ensuite, reverse-cycle air conditioning and a TV

Please note: The Lodge must be pre-booked, additional charges apply

